

3/8-16UNC-2A X 6" CARRIAGE BOLTS
WITH SQUARE NUTS AND ROUND WASHERS

3/8-16UNC-2A X 1-1/3" BOLT WITH ROUND
WASHER AND LOCKWASHER.

1/2-13UNC-2A X 2" CARRIAGE BOLT
WITH HEX NUT, LOCKWASHER, EXTERNAL
TOOTH LOCKWASHER, AND ROUND
WASHER

NOTES:

1.) MATERIAL: STEEL, HOT DIP GALVANIZED PER ASTM
A153 (LATEST REVISION).

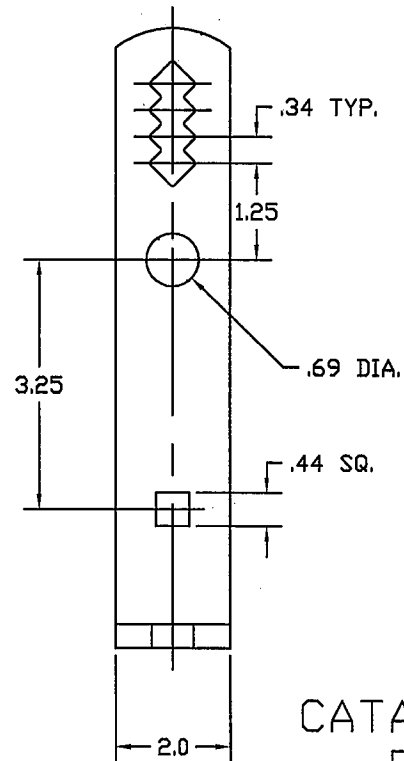

CATALOG NUMBER:
PSC2060715

CHANCE
TOLERANCE CHART



HUBBELL POWER SYSTEMS

TITLE NEMA STANDARD
CROSSARM BRACKET

CONFIDENTIAL: THIS DRAWING AND ITS
CONTENTS ARE CONFIDENTIAL AND THE
EXCLUSIVE PROPERTY OF HUBBELL
POWER SYSTEMS. NO PUBLICATION,
DISTRIBUTION OR COPIES MAY BE MADE
WITHOUT THE WRITTEN CONSENT OF
HUBBELL POWER SYSTEMS.
HUBBELL POWER SYSTEMS UNPUBLISHED
ALL RIGHTS RESERVED UNDER THE
COPYRIGHT LAWS.

SIZE	DWG NO.	CAT / PART / ASSY NO.	REV
SB	SA206-0715	PSC206-0715	---
DO NOT SCALE THIS DRAWING	DRN BY J.J.L.	DATE 07/23/08	SHEET 01 OF 01